

CER

End Suction Volute Pumps

NEW

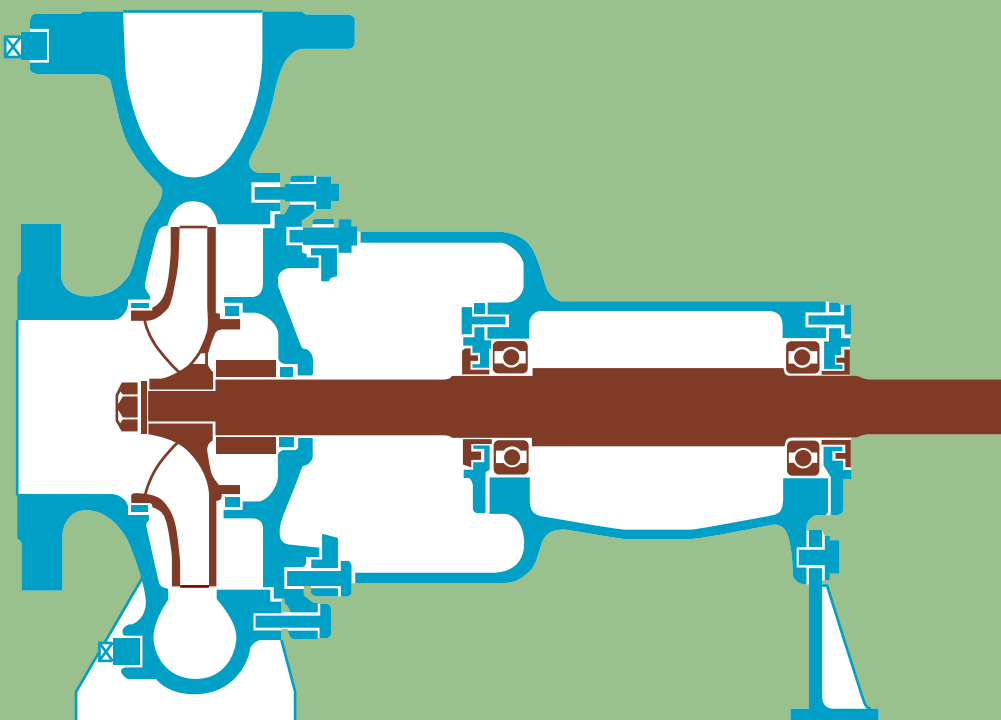

Relible Designs satisfying Expectations

Newly-designed pumps aimed for the growing product line up!

CER

High-quality Standard Pumps

Bearing Case

The bearing case, coupled with sturdy shaft and smooth-running ball bearings, ensures stable pump operation. The case features a construction for outdoor use so that pump can be installed anywhere.

Ball Bearing

Non-contact, grease-lubricated, deep groove ball bearings are used. Thanks for heat-resistant grease used for lubricating the bearings, the pump can withstand high temperature.

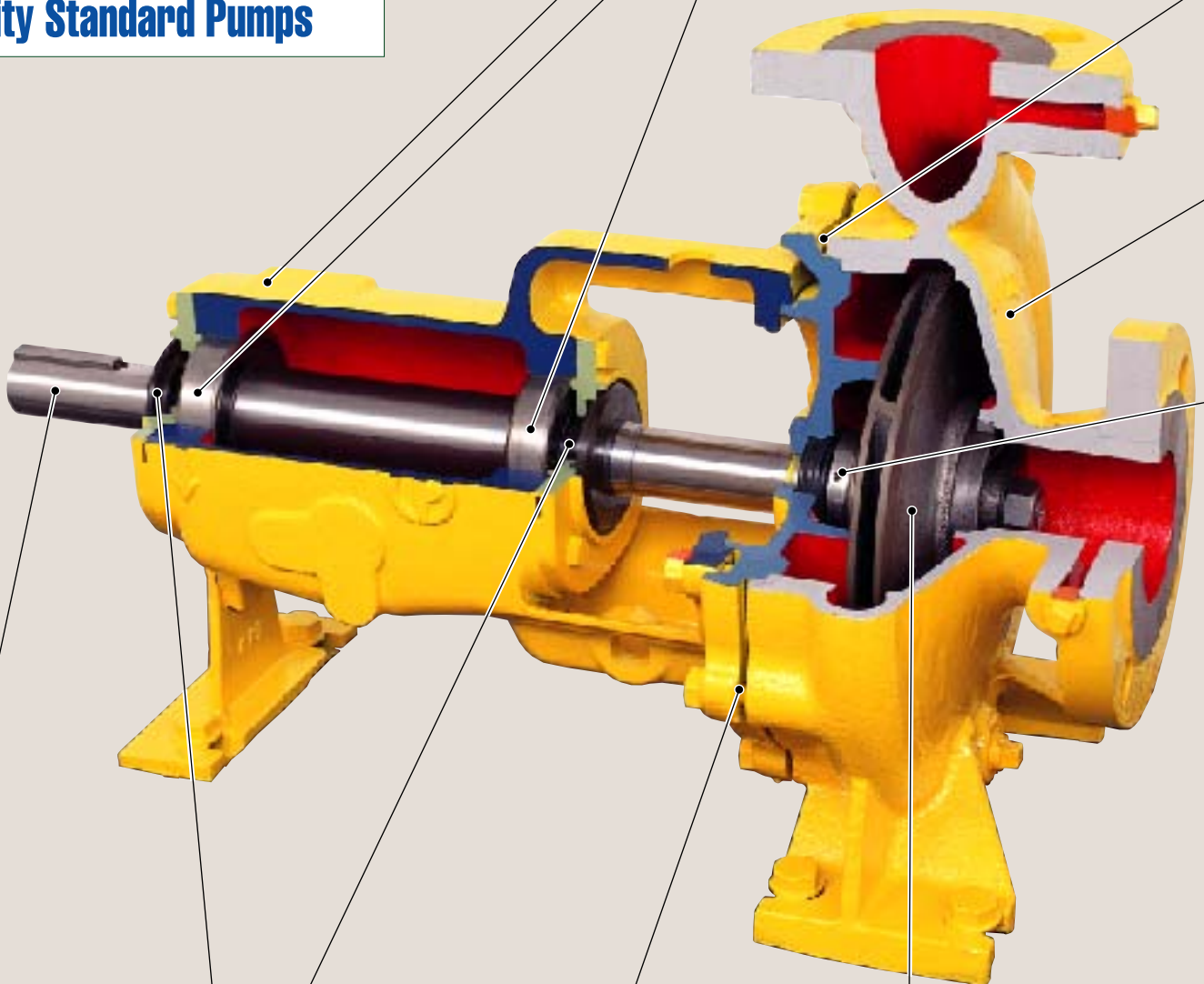

Sturdy Shaft

The standard material for the shaft is SUS 420 J2. The shaft is strong enough even when used for two-pole execution.

Labyrinth Ring

The non-contact labyrinth ring has excellent dustproof and waterproof performance. It also contributes to the pump's highly efficient operation.

Back Pull-Out Construcion

The back pull-out construction allows the rotating assembly to be removed without disconnecting the piping. Disassembly and inspection are simple.

High-Efficiency Impeller

The closed impeller, available in a two-dimensional or three dimensional type, makes use of new hydraulics for assuring higher efficiency.



Non-Asbestos Packing

Non-asbestos packings are used, taking environmental preservation into account.

Volute Casing

The volute casing has integrally cast pump feet, helping back pull-out construction. In addition, the suction and discharge nozzles are arranged end-top to resist piping loads.

One-Touch Seal

A one-touch mechanical seal is used for easy setting. The sealing effectiveness of the shaft seal is extremely stable.



Specifications

Dis.Pres.	up to 0.98MPa(10kgf/cm ²)
Suc.Pres.	up to 0.5MPa(5kgf/cm ²)
Total head	up to 98m
Capacity	up to 720m ³ /hr(12m ³ /min)
Temp.	- 10to+80°C

For special requirements, including handling of heat transfer oils, the CER pumps are available in various constructions and materials. Please contact us for details.

Applications



Building installation, district heating and cooling:

Cold water circulation, cooling water circulation, hot water circulation, boiler water feeding, water supply, fire-fighting.

Industrial machinery:

As a component of unit products of set manufacturers, circulations of heat transfer oils.

Chemical industry:

Water supply, drainage, various other processes.

General industries:

Water supply, drainage

Water services:

Water intake, water supply, water distribution, water for industrial use.

Agriculture:

Irrigation, sprinkling.

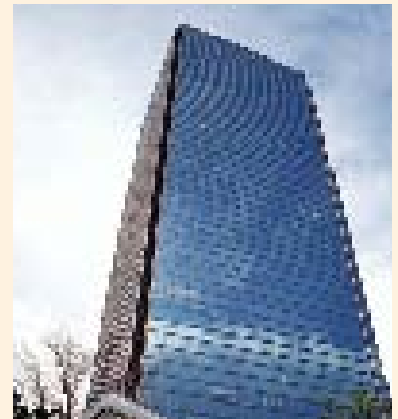
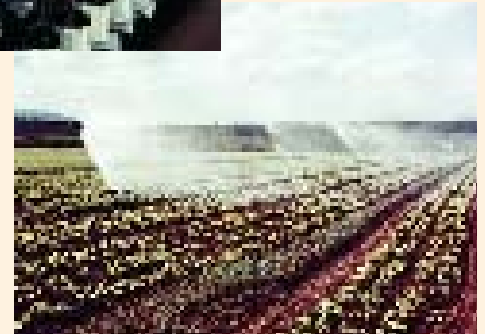

Selection Chart

--- Shows motor rating in kW.

**50Hz
-2P**

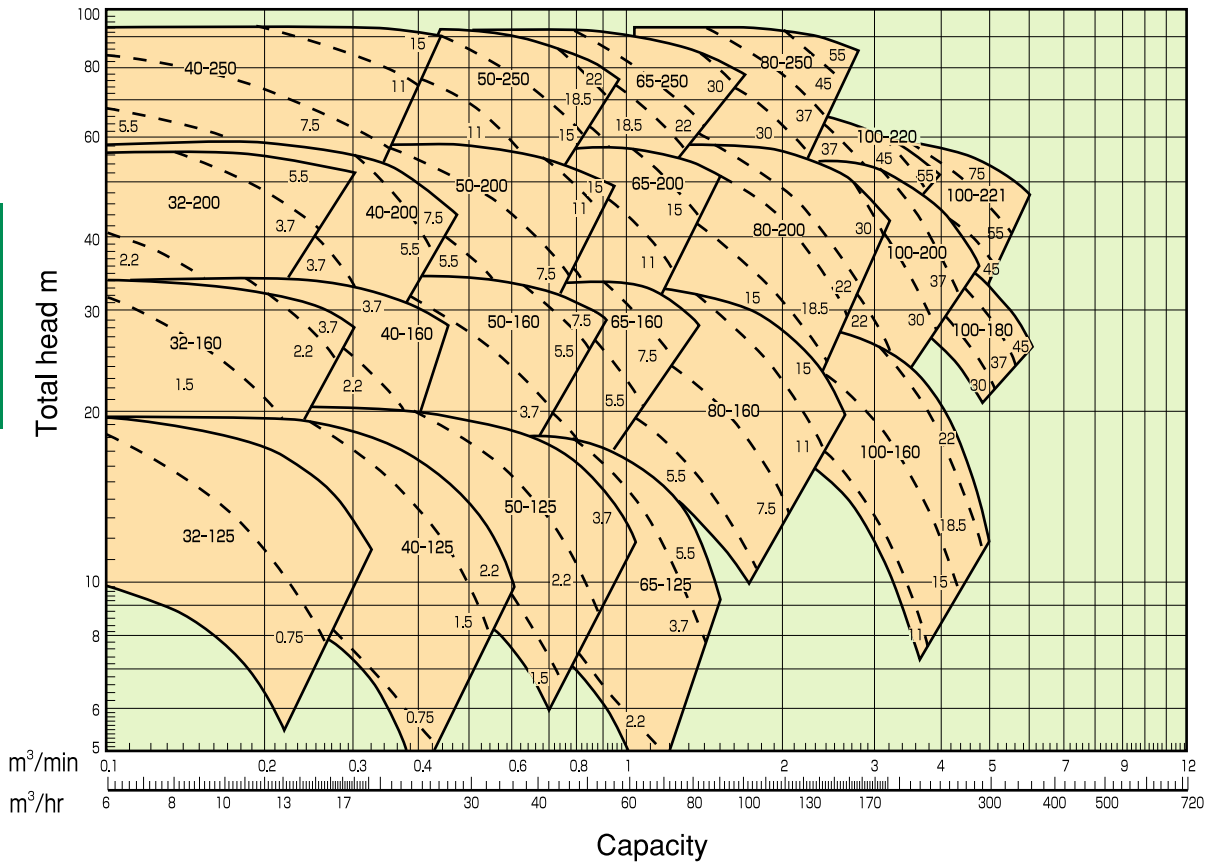

**60Hz
-2P**

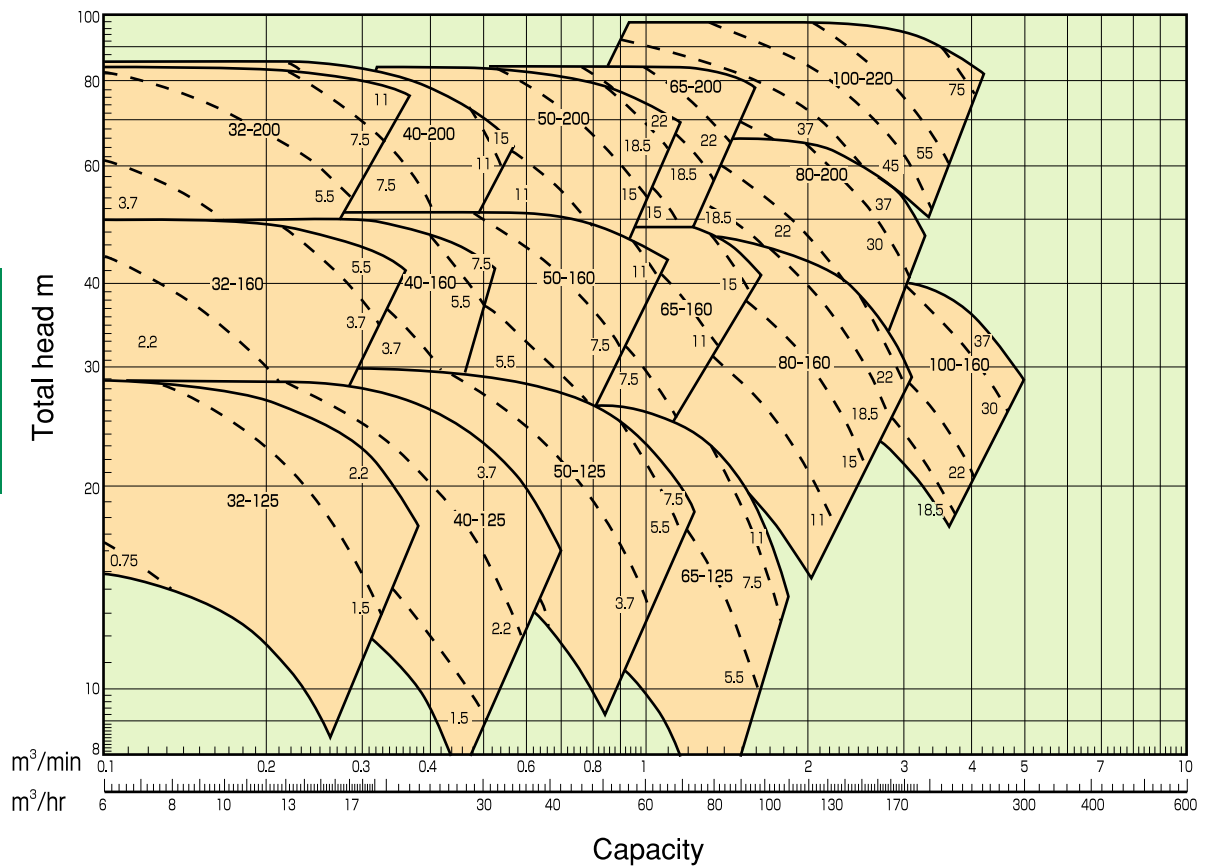

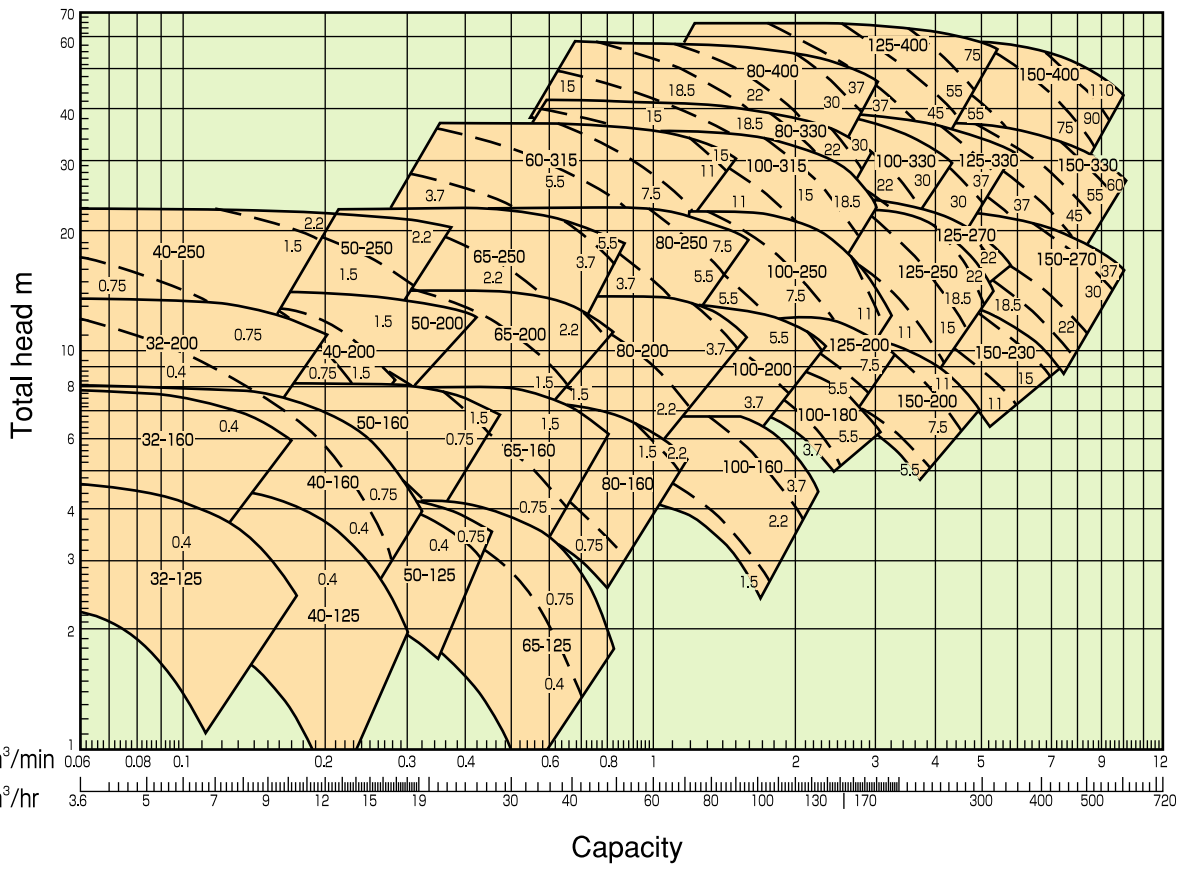

**50Hz
-4P**

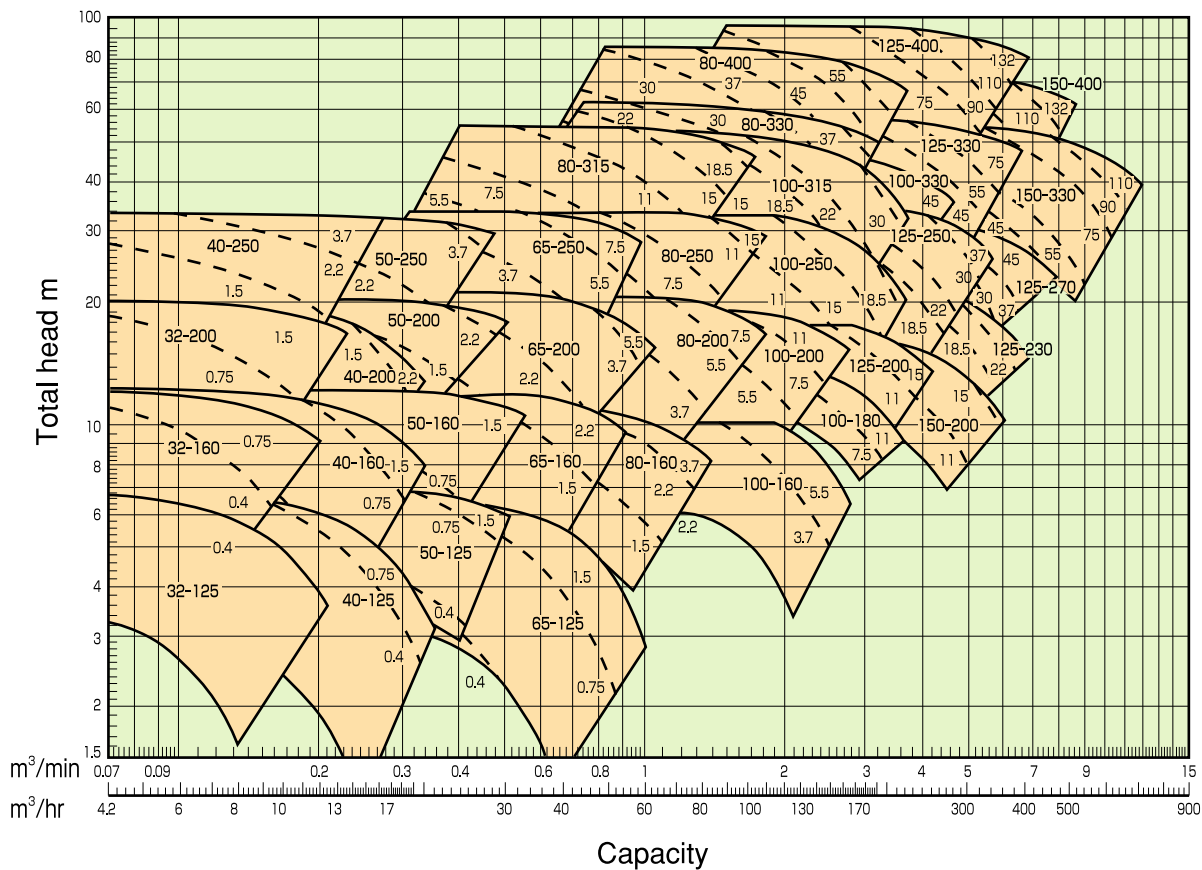

**60Hz
-4P**

Dimensional Drawing

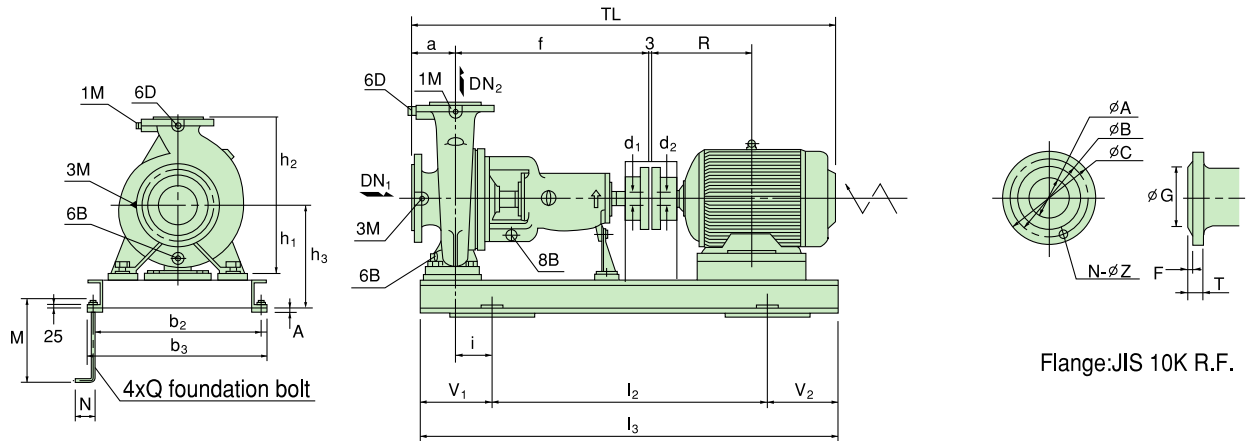

Dimension Table

(Unit:mm)

Sizes	Pump dimensions								Motor dimensions		Baseplate dimensions				Foundation dimensions									
	DN ₁	DN ₂	a	d _{1k6}	f	h ₁	h ₂	Wt. (kgf)	Sizes	R	b ₃	l ₃	A	Wt. (kgf)	h ₃	i	b ₂	l ₂	M	N	Q	V ₁	V ₂	TL
32-125 40-125	40 50	32 40	80 80	24 24	364 364	112 112	140 140	25 26	71M	120	320	670	0	27	202	49	290	420	200	50	M12	105	145	685
									80M	140	320	670	0	27	202	49	290	420	200	50	M12	105	145	751
									90L	168.5	320	750	0	28	202	59	290	480	200	50	M12	115	155	795
									100L	193	320	750	0	28	202	59	290	480	200	50	M12	115	155	822
									112M	200	320	750	0	27	202	59	290	480	200	50	M12	115	155	842
32-160 40-160 50-125 50-160 65-125	40 50 65 65 80	32 40 50 50 65	80 80 80 80 100	24 24 24 24 24	364 364 364 364 364	132 132 132 132 132	160 160 160 160 180	26 27 28 29 31	71M	120	320	670	0	28	222	49	290	420	200	50	M12	105	145	705
									80M	140	320	670	0	28	222	49	290	420	200	50	M12	105	145	771
									90L	168.5	320	750	0	30	222	59	290	480	200	50	M12	115	155	810
									100L	193	320	750	0	29	222	59	290	480	200	50	M12	115	155	842
									112M	200	320	750	0	28	222	59	290	480	200	50	M12	115	155	862
									132S	239	350	870	0	31	222	94	320	600	200	50	M12	150	120	930
									160M	323	430	1000	0	41	250	114	400	660	200	50	M12	170	170	1056
									160L	345	430	1000	0	41	250	114	400	660	200	50	M12	170	170	1111
									180M	351.5	430	1000	0	43	270	114	400	660	200	50	M12	170	170	1142
									71M	120	320	670	0	30	250	49	290	420	200	50	M12	105	145	705
32-200 65-160	40 80	32 65	80 100	24 24	364 364	160 160	180 180	32 31	80M	140	320	670	0	30	250	49	290	420	200	50	M12	105	145	771
									90L	168.5	320	750	0	33	250	59	290	480	200	50	M12	115	155	810
									100L	193	320	750	0	33	250	59	290	480	200	50	M12	115	155	842
									112M	200	320	750	0	32	250	59	290	480	200	50	M12	115	155	862
									132S	239	350	870	0	34	250	94	320	600	200	50	M12	150	120	930
									160M	323	430	1000	0	39	250	114	400	660	200	50	M12	170	170	1056
									160L	345	430	1000	0	39	250	114	400	660	200	50	M12	170	170	1111
									180M	351.5	430	1000	0	42	270	114	400	660	200	50	M12	170	170	1142
									80M	140	320	670	0	30	250	41	290	420	200	50	M12	105	145	771
									90L	168.5	320	750	0	33	250	51	290	480	200	50	M12	115	155	810
40-200	50	40	80	24	356	160	180	32	100L	193	320	750	0	33	250	51	290	480	200	50	M12	115	155	842
									132S	239	350	870	0	34	250	86	320	600	200	50	M12	150	120	930
									160M	323	430	1000	0	39	250	106	400	660	200	50	M12	170	170	1056
									160L	345	430	1000	0	39	250	106	400	660	200	50	M12	170	170	1111
									180M	351.5	430	1000	0	42	270	106	400	660	200	50	M12	170	170	1142
									80M	140	320	750	0	30	250	45	290	480	200	50	M12	115	155	884
									90L	168.5	320	870	0	30	250	80	290	600	200	50	M12	150	120	923
									100L	193	320	870	0	30	250	80	290	600	200	50	M12	150	120	955
									112M	200	320	870	0	29	250	80	290	600	200	50	M12	150	120	975
									132S	239	350	1000	0	33	250	100	320	660	200	50	M12	170	170	1043
40-250 50-200	50 65	40 50	80 100	32 32	460 460	160 160	225 200	44 41	160M	323	430	1120	0	36	250	120	400	740	200	50	M12	190	190	1169
									160L	345	430	1120	0	36	250	120	400	740	200	50	M12	190	190	1224
									180M	351.5	430	1120	0	36	250	120	400	740	200	50	M12	190	190	1151
									200L	395.5	470	1250	10	63	317	135	430	840	200	63	M16	205	205	1376
									90L	168.5	380	870	0	36	270	65	350	600	200	50	M12	150	120	951
50-250	65	50	100	32	460	180	225	45	100L	193	380	870	0	38	270	65	350	600	200	50	M12	150	120	983
									112M	200	380	870	0	38	270	65	350	600	200	50	M12	150	120	1003
									132S	239	430	1000	0	42	270	85	400	660	200	50	M12	170	170	1071
									132S	239	430	1000	0	42	270	85	400	660	200	50	M12	170	170	1071

- TL dimensions are reference only
- *: shows dimensions in case of drip-proof type motor. Other dimensions are same regardless of motor types.



TORISHIMA PUMP MFG. CO., LTD.

Head Office & Works: 1-1-8, Miyata-cho, Takatsuki City, Osaka, Japan. Phone: 072-695-0551 Telefax: 072-693-1288

TORISHIMA SINGAPORE

SINGAPORE BRANCH 30 Ubi Crescent #01-02 Ubi Techpark Singapore 408566 Phone: (65)6779-0123 Telefax: (65)6779-6900

TORISHIMA HONG KONG

TORISHIMA (HONG KONG) LIMITED Unit 603, 6/F., Tower III, Enterprise Square, 9 Sheung Yuet Road, Kowloon Bay, Kowloon, Hong Kong
Phone: (852)2795-1838 Fax: (852)2754-3293

TORISHIMA MALAYSIA

TORISHIMA MALAYSIA SDN.BHD Suite 1906, 19th Floor Kenanga International Jalan Sultan Ismail 50250 Kuala Lumpur, Malaysia
Phone: (603)2715-0068 Fax: (603)2715-0019

TORISHIMA INDONESIA

P.T. TORISHIMA GUNA INDONESIA JL Rawa Sumur Timur No.1, Pulogadung Industrial Estate, P.O. Box.:1160 JAT., Jakarta 13930, Indonesia
Phone: (62)21-460-3963,(62)21-460-3964,(62)21-480-0205 Fax:(62)21-460-3937

P.T. TORISHIMA GUNA ENGINEERING JL Rawa Sumur Timur No.1, Pulogadung Industrial Estate, P.O. Box.:1160 JAT., Jakarta 13930, Indonesia
Phone: (62)21-460-3963,(62)21-460-3964,(62)21-480-0205 Fax:(62)21-460-3937

P.T. GETEKA FOUNINDO JL Rawa Sumur Timur No.1, Pulogadung Industrial Estate, P.O. Box.:1160 JAT., Jakarta 13930, Indonesia
Phone: (62)21-460-3936,(62)21-460-3937 Fax: (62)21-460-3937

TORISHIMA U.A.E

MIDDLE EAST OFFICE 5th Floor, office No.503, Al Salmeeen Golden Tower, P.O. Box.:72197, Electra Street, Abu Dhabi. U.A.E
Phone: (971)2-6743880 Fax:(971)2-6743881

TORISHIMA U.K.

EUROPE OFFICE 20/23 Woodside place Glasgow G3 7QF, Scotland, United Kingdom Phone: (44)141-304 4546 Fax:(44)141-332 4927

TORISHIMA U.S.

U.S. OFFICE 82B Daniels Road, Charlton, MA01507, United States of America Phone: (1)866-374-1130 Fax:(1)508-248-9321